



With the electric **YAKwheel**, rescue operations can be conducted **faster, safer, and more efficiently** than ever before. Our innovative products empower rescuers to **effortlessly navigate** even the most challenging terrains, ultimately saving more lives.

The drive unit is intended exclusively for substitution of the regular bike wheel used for **TYROMONT Mountain Stretcher Tyral** and may not be used for other purposes.

One of the key features of YAKwheel is **regenerative braking** which helps reducing the speed while descending with an injured person.

### Technical specifications:

Total weight	Kg	8
Maximum speed	Km/h	6
Maximum torque	Nm	40
Battery rated voltage	V	40
Battery capacity	Ah	6
Motor power	W	250
Battery estimated range	h	2 or more
Operating temperature	°C	-20...+65

The **remote control** enables users to adjust **speed, regenerative braking** intensity with a single throttle, and **direction**. It can be used by the rescuer carrying the stretcher or even by another rescue not carrying the stretcher.

## What is included?

1. Electric wheel
2. 2x Battery 40V
3. Motor controller
4. Remote control
5. Charger battery 40V
6. Charger remote control

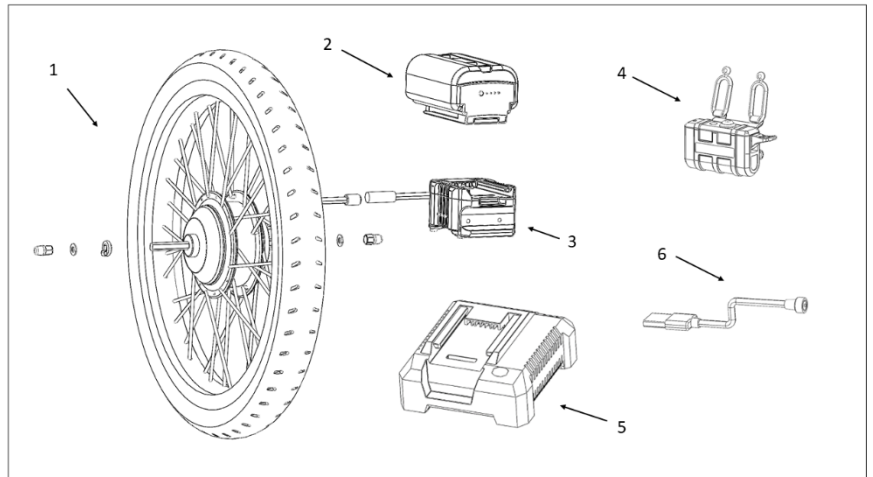

## Assembly:

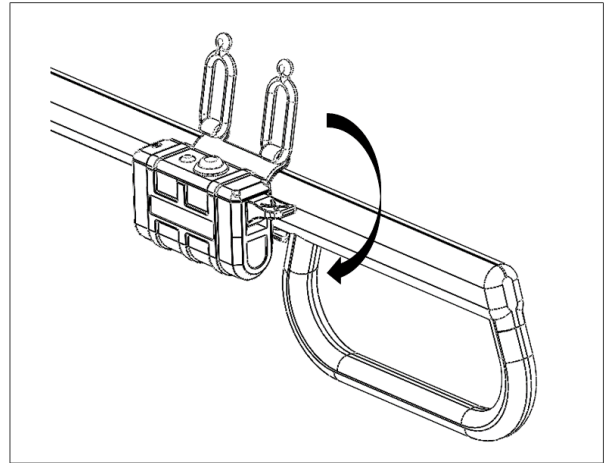
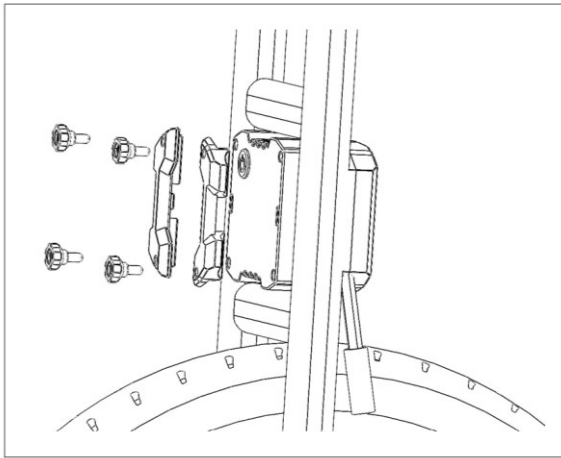

## Remote control:

1	Charging port
2	ON/OFF Switch - charging status
3	LED battery status
4	Forward/Reverse
5	Throttle

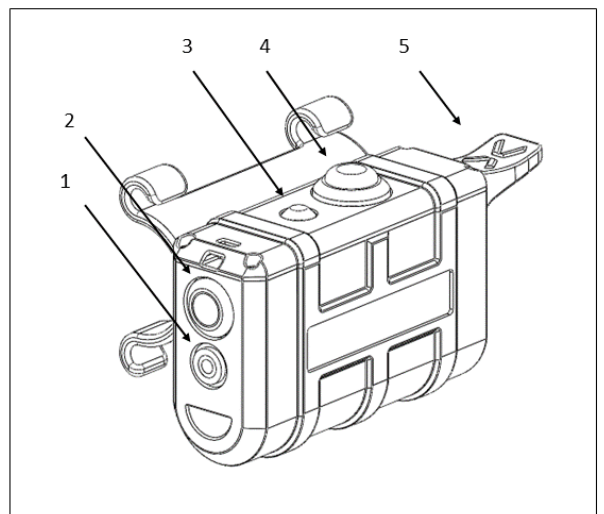

## General performance:

- Motor controller activation triggers automatic activation of electronic brakes.
- When the remote control is ON without throttle input, wheel brakes engage. Throttle activation releases brakes.
- Avoid simultaneous throttle pressing and remote activation.